





## Mezzanine and Ground

- Fully DDA Compliant
- Fully carpeted exhibition and conference halls
- In house floor plan design service
- Manned service desk during build up and breakdown
- Access for goods direct to hall
- Hall heating and general lighting
- Secure exhibitor storage area available throughout tenancy
- Complimentary Cleaning Services to venue areas
- Digital Directional Signage
- Organiser Car Parking for event duration
- Free WiFi Open Zone (Higher bandwidth upgrade available)
- 💧 Water refill stations
- ⚡ Charging stations

## Registration Desk in the foyer

- Wired Internet Connection Available
- Dedicated phone line
- Power sockets
- Purpose built cloakroom facilities
- Digital signage screens

## Organiser's Office space

- Reception Area
- Private Office
- Personal Kitchen
- Photocopier
- Phones
- Free Wi-Fi Available
- Television
- Tannoy to main hall for announcements

## Digital Signage Locations

- Graphics to be provided by organiser (1080W x 1920L) in JPEG format
- For PowerPoint templates contact your Project Manager
- All graphics to be provided no later than 5 working days prior to your event for approval by your Project Manager.
- ★ These screens are for Mezzanine events
- ★ These screens are for Gallery Hall and Atrium events

## Stairwells

There are 2 goods lifts in the Loading Bay for the delivery of stand materials and exhibits.

### Main Hall / SWG

- Goods lift Size - 3900mm Long x 1900mm Wide x 1900 High
- Goods lift Capacity – 3000kg

Door 1	Door 2	Door 3
• 1.8m (w) x 2m (h)	• 1.8m (w) x 2m (h)	• 1.8m (w) x 2m (h)

### Gallery Hall / SWF

- Goods lift Size – 5500mm Long x 2550mm Wide x 1900mm High

Door 1	Door 2	Door 3
• 1.53m (w) x 1.9m (h)	• 1.37m (w) x 1.9m (h)	• 1.35m (w) x 1.9m (h)

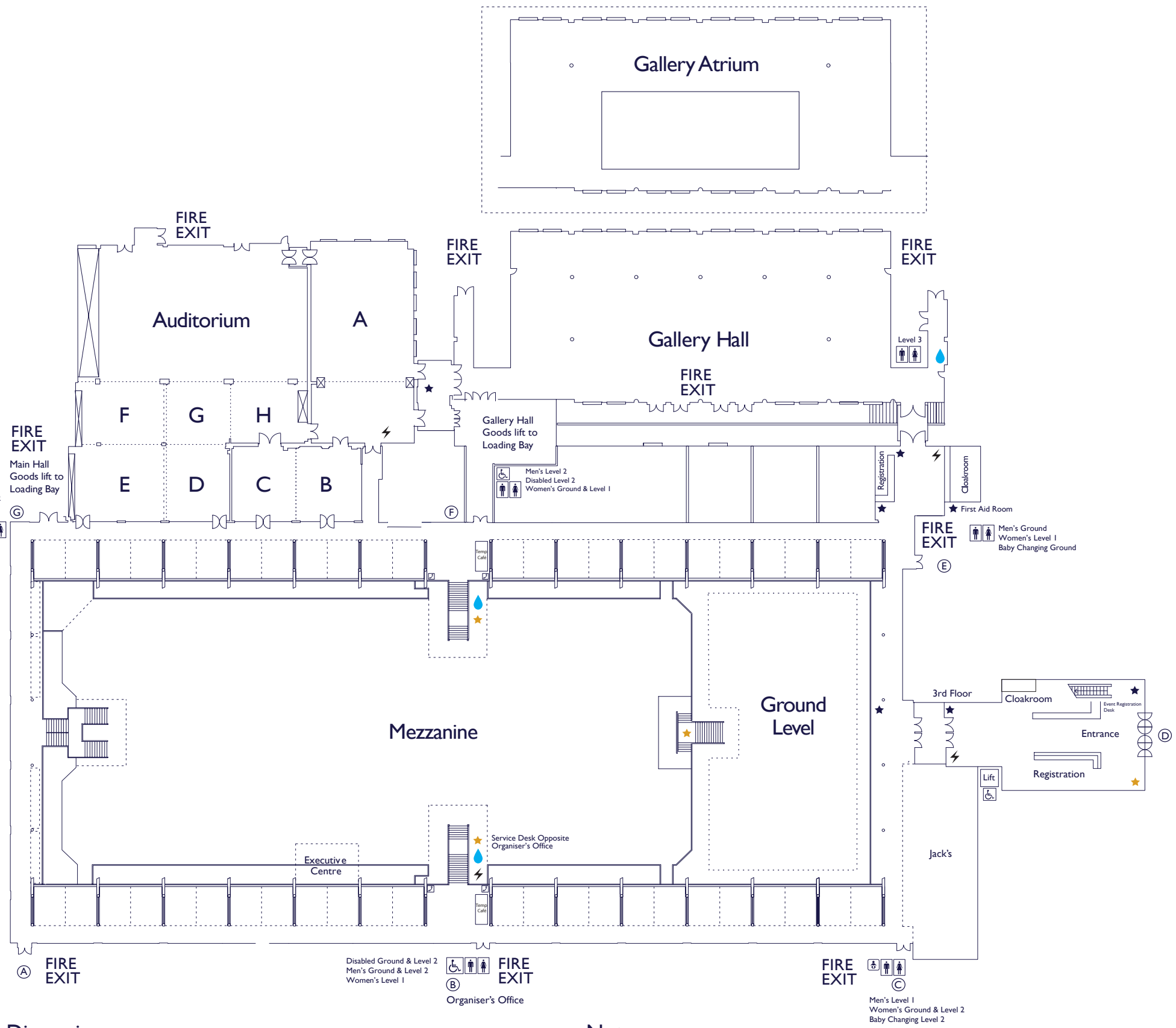

## Dimensions

	Gross Space	Net Space	Length (M)	Width (M)	Height (M)
Mezzanine	2088m <sup>2</sup>	1338 m <sup>2</sup>	70.37	30.70	16.5
Ground Level	471.5m <sup>2</sup>	352.5m <sup>2</sup>	15.49	32.0	-
Gallery Bays	1468m <sup>2</sup>	1010m <sup>2</sup>	7.02	4.67	3.0
Gallery Hall	837m <sup>2</sup>	507m <sup>2</sup>	42.7	19.75	6.85
Gallery Atrium	558m <sup>2</sup>	363m <sup>2</sup>	42.69	19.75	2.75
Conference Centre	1140m <sup>2</sup>	840m <sup>2</sup>			
<b>Total</b>	<b>6565.5m<sup>2</sup></b>	<b>4430.5m<sup>2</sup></b>			

## Notes:

---



---



---



---



---



---